

SNAP FIT & EAR CLAMPS

Double Ear Hose Clamp (O-clip)

HCL's Double Ear Hose Clip (O Clip) is manufactured from a choice of materials and is an economical solution for many simple hose assemblies. The two ears give the clip extra grip and help maintain constant pressure around the hose. The practical design of the clamp means that they clamp firmly onto the assembly and cannot be removed.

PERFORMANCE	Strength	
	Temperature	
	Speed	
	Weathering	
	Chemical	
	Dynamic Range	

Applications

- Automotive
- Vending
- White Goods
- General Industry



Materials – see section 10.3

- **W1** Zinc Plated Steel

On Request

- **W4** 304 SS

Weathering	
Chemical	

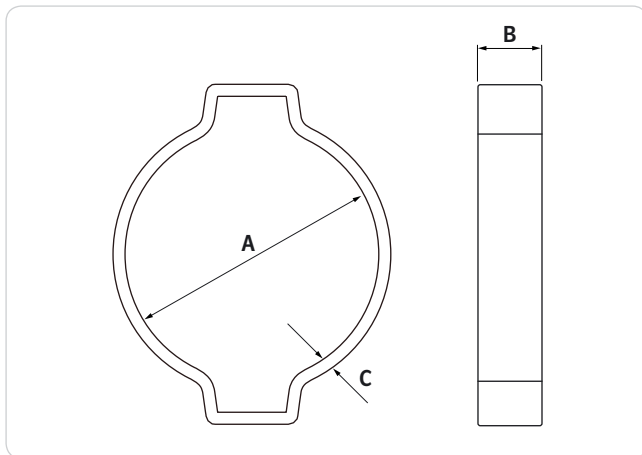

HCL Part No	Diameter Range (A) mm	Band Width (B) mm	Band Thickness (C) mm	Box Quantity
DEC-5	5 – 7	6.0	0.6	100
DEC-7	7 – 9		0.8	
DEC-9	9 – 11	6.5	0.9	
DEC-11	11 – 13		1.0	
DEC-13	13 – 15	7.0	1.2	
DEC-14*	14 – 17			
DEC-15	15 – 18	7.5	1.3	
DEC-17	17 – 20			
DEC-18	18 – 21	8.0	1.4	
DEC-20	20 – 23			
DEC-22	22 – 25	8.5	1.6	
DEC-23*	23 – 27			
DEC-25*	25 – 28	9.0		
DEC-28*	28 – 31			
DEC-31*	31 – 34	9.5		
DEC-34*	34 – 37			
DEC-37*	37 – 40	10.0		
DEC-40*	40 – 43			
DEC-43*	43 – 45	10.5		

Part numbers marked with * are only available in W1 Material
 All weights, dimensions & quantities are subject to a 2.5% tolerance.
 To add material selection to the HCL Part No: for W4, add "W4".

Installation Tools – see section 9.1



MT-EC-VHT-01

MT-EC-VT-01